



Application

They are used in radio electronic and radio engineering equipment as connectors of the general type.

Standarts

OST V 11 0121-91
GEO.364.120 Specification

Design description

- screw mating
- climatic version V

- contacts plating: silver
- mounting method: soldering

Characteristics

Mechanical

vibration:

frequency range, Hz - 1...1000
acceleration, m/s² - 100 (10g)

single impacts:

acceleration, m/s² - 10000 (1000g)

multiple impacts:

acceleration, m/s² - 1500 (150g)

linear loads:

acceleration, m/s² - 2000 (200g)

Reliability requirements

minimum operating time, h

1000

with mate-unmate operations

500

minimum storage life, years

15

Electric

maximum operating voltage, (amplitude value), not more than
700 V

operating current across the contact, ref. contacts location diagrams

resistance of electric contact, not more than, mOhm

Ø1,5 - 2,5

Ø2,5 - 1,0

Ø3,5 - 0,75

Ø5,5 - 0,3

Ø9,0 - 0,15

insulation resistance in normal climatic conditions, not less than
1000 MOhm

Climatic

ambient air temperature, from minus 60 - to plus 100°C

change of temperature, from minus 60 °C- to plus 180°C (taking into account the temperature of contacts overheat)





atmospheric pressure decrease, operating Pa (mm.Hg)
1,3x10⁻⁴ (1x10⁻⁶)

Designation									
	2RTT	20	B	P	N	4	G	6	V
Type									
Dimension type									
Type of housing:									
B- modular (fixed type)									
K - cable type									
Type of pipe:									
P - straight									
U - angled type									
Type of pipe nut									
EA - for shielded cable									
N - for non-shielded cable									
Number of contacts									
Connector portion:									
SH - plug (male connector)									
G - socket (female connector)									
Combination of contacts (ref. contacts location diagrams)									
Universal climatic version									











Designation while placing the order:

Plug 2RTT48BPN2SH24V GE0.364.120 Specification
 Socket 2RTT48KUEA2G24V GE0.364.120 Specification

Conventional designation of the contacts

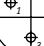
Diameter	1,5	2,5	3,5	5,5	9,0
Conventional designation of the contact					

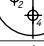
Contacts location diagrams

Connector conventional dimension	Contacts location diagrams	Contact combination number	Contact diameter, mm	Number of contacts	Operating current, A
12		1	2,5	1	25
16		2	3,5	1	50
		3	1,5	2	10
20		4	2,5	2	25
		5	2,5	3	25
		38	1,5	3	10
		6	2,5	4	25
		39	1,5	4	10
		40	2,5	5	25
		7	1,5	5	10
					

Type of connectors 2RTT



Connector conventional dimension	Contact location diagrams	Contact combination number	Contact diameter, mm	Number of contacts	Operating current, A
28		8	5,5	1	100
		9	3,5	2	50
		10	2,5	2	25
			3,5	2	50
		11	2,5	7	25
	41	1,5	7	10	
32		12	9,0	1	200
		13	2,5	3	25
			5,5	1	100
		14	2,5	8	25
		42	1,5	8	10
		15	1,5	6	10
			2,5	4	25
	16	1,5	6	10	
		2,5	6	25	
36		17	2,5	3	25
			9,0	1	200
		18	3,5	5	50
		19	1,5	3	10
			2,5	3	25
3,5			1	50	

Gagarin ave, 98, Kharkov, Ukraine 61140 tel 057 737-36-88, fax 057 736-07-60

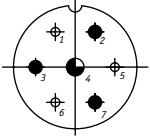
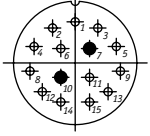
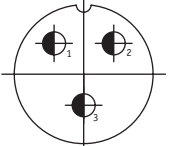
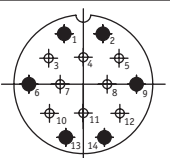
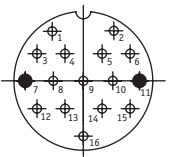
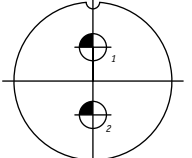
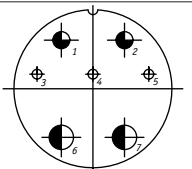
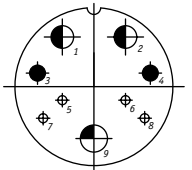
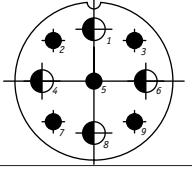
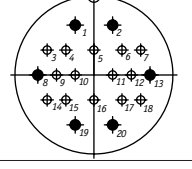
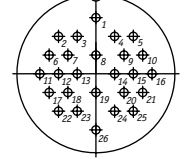
Connector conventional dimension	Contact location diagrams	Contact combination number	Contact diameter, mm	Number of contacts	Operating current, A
36		19	1,5	3	10
			2,5	3	25
		20	1,5	13	10
			2,5	2	25
40		21	5,5	3	100
		22	1,5	8	10
			2,5	6	25
		23	1,5	14	10
			2,5	2	25
	48		24	9,0	2
		25	1,5	3	10
			3,5	2	50
			5,5	2	100
		26	1,5	4	10
			2,5	2	25
			5,5	2	100
			9,0	1	200
		27	2,5	5	25
			5,5	4	100
		28	1,5	14	10
	2,5		6	25	
	29	1,5	26	9	

Type of connectors 2RTT



Connector conventional dimension	Contact location diagrams	Contact combination number	Contact diameter, mm	Number of contacts	Operating current, A
55		30	2,5	3	25
			9,0	3	200
		31	1,5	16	9
			2,5	2	22
			3,5	3	45
			5,5	2	90
		32	1,5	22	9
			2,5	8	22
		33	1,5	14	8
			2,5	14	20
3,5			3	40	
	34	1,5	33	8	
		3,5	2	40	
60		35	1,5	14	8
			2,5	14	20
			3,5	2	40
			5,5	1	80
		36	1,5	25	7
			2,5	20	17
		37	1,5	40	7
			2,5	7	17

Design and dimensions of connectors 2RTT are shown in figures 1-9 and tables 1-9

Gagarin ave, 98, Kharkov, Ukraine 61140 tel 057 737-36-88, fax 057 736-07-60

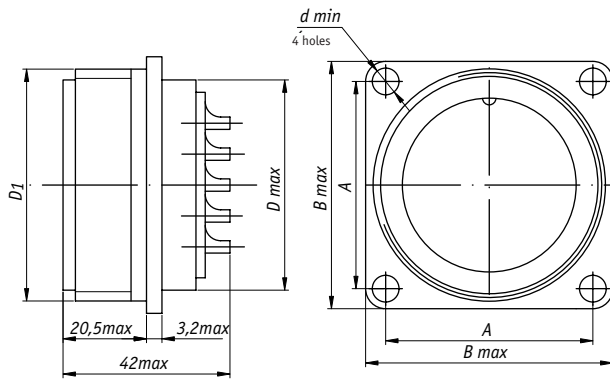

Figure 1 - Fixed connector plugs and sockets (modular B)

Table 1

Connector conventional dimension	Dimensions, mm				
	A	B	D	D ₁	d
12	16±0,1	22	12	M16x1,5	3,2
16	19±0,1	25	16	M20x1,5	3,2
20	22±0,1	30	20	M24x1,5	3,2
28	30±0,2	38	28	M33x1,5	3,5
32	32±0,2	40	32	M36x1,5	3,5
36	34±0,2	42	36	M39x1,5	3,5
40	40±0,1	48	40	M45x1,5	3,5
48	48±0,2	58	48	M52x1,5	4,5
55	52±0,2	64	55	M60x1,5	4,5
60	54±0,2	68	60	M64x1,5	4,5

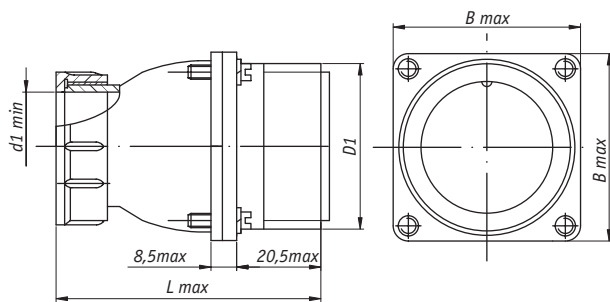

Figure 2 - Fixed connector plugs and sockets (modular BPEA) with straight pipe and nut for shielded cable

Table 2

Connector conventional dimension	Dimensions, mm			
	B	D ₁	d	L
12	22	M16x1,5	8	57
16	25	M20x1,5	11	57
20	30	M24x1,5	18	61
28	38	M33x1,5	25	65
32	40	M36x1,5	25	69
36	42	M39x1,5	29	71
40	48	M45x1,5	32	71
48	58	M52x1,5	36	73
55	64	M60x1,5	46	73
60	68	M64x1,5	50	71

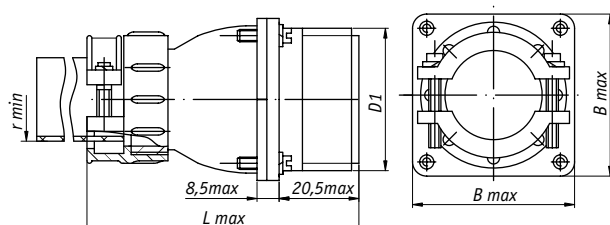

Figure 3 - Fixed connector plugs and sockets (modular BPN) with straight pipe and nut for non-shielded cable

Table 3

Connector conventional dimension	Dimensions, mm			
	B	D ₁	r	L
12	22	M16x1,5	2,0	72
16	25	M20x1,5	3,0	72
20	30	M24x1,5	6,0	75
28	38	M33x1,5	9,0	82
32	40	M36x1,5	9,0	86
36	42	M39x1,5	10,5	89
40	48	M45x1,5	11,5	89
48	58	M52x1,5	15,0	91
55	64	M60x1,5	19,0	91
60	68	M64x1,5	22,5	89

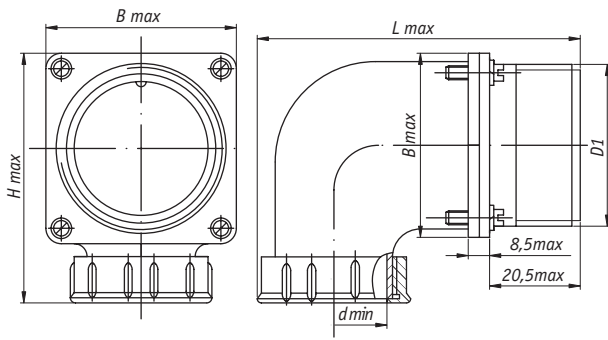

Figure 4 - Fixed connector plugs and sockets (modular BUEA) with elbow pipe and nut for shielded cable

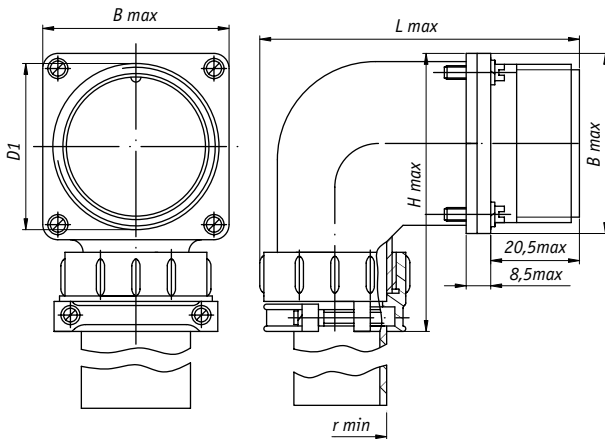

Figure 5 - Fixed connector plugs and sockets (modular BUN) with elbow pipe and nut for non-shielded cable

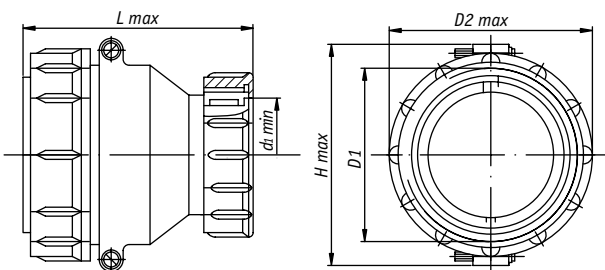

Figure 6 - Cable connector plugs and sockets (KPEA) with straight pipe and nut for shielded cable

Table 4

Connector conventional dimension	Dimensions, mm				
	B	H	D ₁	d	L
12	22	41	M16x1,5	8	60
16	25	44	M20x1,5	11	64
20	30	48	M24x1,5	18	72
28	38	59	M33x1,5	25	82
32	40	61	M36x1,5	25	82
36	42	63	M39x1,5	29	85
40	48	69	M45x1,5	32	90
48	58	79	M52x1,5	36	98
55	64	85	M60x1,5	46	106
60	68	89	M64x1,5	50	110

Table 5

Connector conventional dimension	Dimensions, mm				
	B	H	D ₁	r	L
12	22	56	M16x1,5	2,0	59
16	25	57	M20x1,5	3,0	63
20	30	62	M24x1,5	6,0	71
28	38	76	M33x1,5	9,0	83
32	40	78	M36x1,5	9,0	83
36	42	80	M39x1,5	10,5	84
40	48	86	M45x1,5	11,5	90
48	58	96	M52x1,5	15,0	99
55	64	102	M60x1,5	19,0	106
60	68	106	M64x1,5	22,5	106

Table 6

Connector conventional dimension	Dimensions, mm				
	H	D ₁	D ₂	d ₁	L
12	27	M16x1,5	21,5	4,0	56
16	31	M20x1,5	25,5	7,5	56
20	39	M24x1,5	29,5	12,5	60
28	51	M33x1,5	38,5	17,0	62
32	55	M36x1,5	41,5	19,0	64
36	58	M39x1,5	45,5	21,0	68
40	63	M45x1,5	52,5	25,0	70
48	71	M52x1,5	59,5	29,0	72
55	77	M60x1,5	67,5	40,0	72
60	83	M64x1,5	72,5	42,5	70

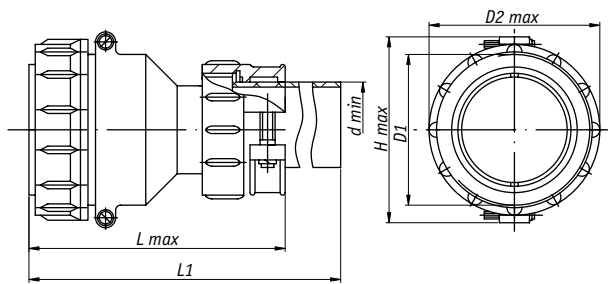

Figure 7 - Cable connector plugs and sockets (KPN) with straight pipe and nut for non-shielded cable

Table 7

Connector conventional dimension	Dimensions, mm				
	H	D ₁	D ₂	r	L
12	27	M16x1,5	21,5	2,0	71
16	31	M20x1,5	25,5	3,0	71
20	39	M24x1,5	29,5	6,0	74
28	51	M33x1,5	38,5	9,0	79
32	55	M36x1,5	41,5	9,0	84
36	58	M39x1,5	45,5	10,5	86
40	63	M45x1,5	52,5	11,5	87
48	71	M52x1,5	59,5	15,0	89
55	77	M60x1,5	67,5	19,0	89
60	83	M64x1,5	72,5	22,5	87

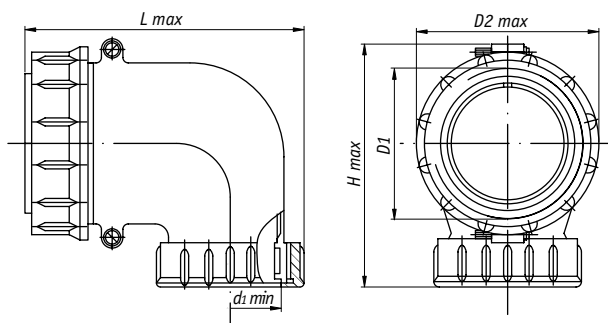

Figure 8 - Cable connector plugs and sockets (KUEA) with elbow pipe and nut for shielded cable

Table 8

Connector conventional dimension	Dimensions, mm				
	H	D ₁	D ₂	d	L
12	44	M16x1,5	21,5	4,0	56
16	48	M20x1,5	25,5	7,5	62
20	57	M24x1,5	29,5	12,0	70
28	69	M33x1,5	38,5	18,0	78
32	72	M36x1,5	41,5	18,0	78
36	74	M39x1,5	45,5	20,0	81
40	80	M45x1,5	52,5	22,5	86
48	87	M52x1,5	59,5	27,0	98
55	95	M60x1,5	67,5	38,0	103
60	101	M64x1,5	72,5	41,0	110

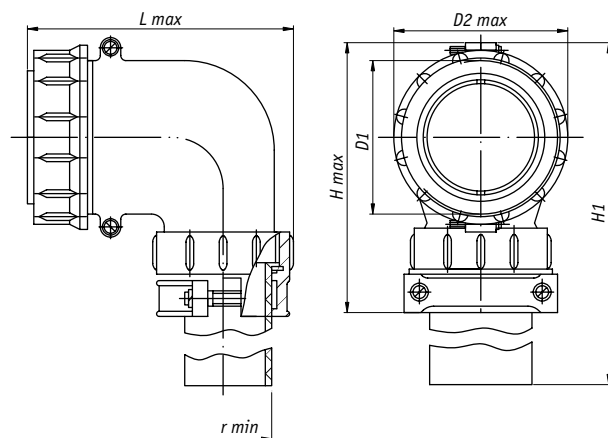

Figure 9 - Cable connector plugs and sockets (KUN) with elbow pipe and nut for non-shielded cable

Table 9

Connector conventional dimension	Dimensions, mm				
	H	D ₁	D ₂	r	L
12	59	M16x1,5	21,5	4,0	56
16	61	M20x1,5	25,5	25,5	63
20	71	M24x1,5	29,5	29,5	70
28	86	M33x1,5	38,5	38,0	80
32	90	M36x1,5	41,5	41,0	80
36	90	M39x1,5	45,5	45,0	81
40	96	M45x1,5	52,5	11,5	87
48	105	M52x1,5	59,5	59,5	98
55	112	M60x1,5	67,5	67,5	104
60	118	M64x1,5	72,5	72,5	113